

RECOMMENDATIONS :

NORTH SECTION - Reservoir No.1

- 1** Increase the density of some of the grass and tufting plants such as Poa, Austrodanthonia, Microloena, Dianella and Lomandra to better cover the ground. Undertake weed removal through hand pulling and some careful spraying now while the vegetation is young.
- Remove the *Permisurus claudens* (Kikuyu) to the mound thoroughly and revegetate with a mix of grass species such as *Melbournia stipoides* (Weeping Grass) and *Austrodanthonia sp* (Wababy Grass).
- Remove the 20-30 recently germinated *Eucalyptus cladocalyx* (Sugar Gum) to avoid any threat to pipework infrastructure located directly underneath.
- Remove concrete slabs and asphalt from past buildings. Revegetate with appropriate grass species when removed.

WEST SECTION - Reservoir No.1

- 4** Install a mirror at the front entrance gate, to allow better visual connection between editing motorcarts and shared trail users. Any new planting of trees and shrubs should be kept away from the boundary fence along High Street and the railway line. Approach Darebin City Council with regard to installing warning signs advising of the vehicle access point along the shared pedestrian trail.
- 5** Formalise the gravel area toward the north end of the site immediately south of the Reservoir railway station car park into a Temporary Operational Zone. Extend the Temporary Operational Zones to the west site boundary adjacent to the Reservoir railway station car park. Protect the existing Eucalypts from vehicle access, storage of materials and compaction around the roots using bollards or post and rail fencing. Protect the area of scattered grassland located to the north west of the proposed storage area.
- 6** During the initial site inspection an area of 200-300m² was identified as being a boggy area. It is likely this is due to a leaking main pipe. Establish indigenous bog-type & wetland plants throughout the wet area.

- 7** Remove woody weeds parallel to the railway line to maintain vehicle access. Protect and allow the existing patches of *Austrosipa* within this area to continue to regenerate, creating native grasslands.

- 8** Supply and plant small, low maintenance shrubs that don't require regular pruning to soften the front of the Melbourne Water Administration Office and allow for clear sight lines to the main entrance gate and High Street. Consider rendering and painting the brickwork to update the buildings presentation and undertake roof maintenance.

- 9** Repair the cracked asphalt vehicle access road leading to the north part of the site. Regularly maintain the kerb and channel from collecting silt and weed growth.

- 10** Control the spread of the *Nassella mesasiama* (Chilean Needle Grass) to the north and north west side of the main entrance through careful spot spraying with herbicide and gradual replacement with appropriate species. Control the spread of *Cynara cardunculus* (Artichoke Thistle) to the south side of the main entrance road. Always follow biosecurity procedures and carry out high standards of vehicle and machine hygiene to minimise seed transferal to other areas of the site and to other sites where the same machinery is used.

- 11** Retain and enhance the significant amount of indigenous vegetation on the embankment to the west side of Reservoir No.1. Possible management practices may include sealing the area annually in September/October and then mowing the Reservoir No.1 could be used as a seed bank by local and indigenous nuzzles and landscape groups. Install a post and rail or 3 strand wire and timber post / star picket fence to restrict access and protect the area. Highlight the importance of the vegetation on the embankment with interpretive signage.

- 12** Remove all woody and annual weeds that are growing in the joints of the bluestone pavers of the batter slopes of Reservoir No.1, due to concern of the structural stability of the reservoir, by periodic spraying of the walls. Continue annual inspections and maintenance regimes.

- 13** Remove all (13No.) existing *Cupressus macrocarpa* (Monterey Cypress) lining the south embankment of Reservoir No.1.

- 14** Select and position the species replacing the *C. macrocarpa* making sure no vegetation will interfere with the adjacent electricity wires. Selected trees to replace the *Cupressus macrocarpa* (Monterey Cypress) could comprise of *Allocasuarina littoralis* (Black Sheoak), *Eucalyptus leucopyllon* subsp. *cornata* (Yellow Gum) and *Acacia melanoxylon* (Blackwood).

- 14** Remove all (34No.) existing *Cupressus macrocarpa* (Monterey Cypress) lining the east embankment of Reservoir No.1. Select and position the species replacing the *C. macrocarpa* making sure no vegetation will overhang the fence to allow people to climb and gain access to the site. Selected trees to replace the *Cupressus macrocarpa* (Monterey Cypress) could comprise of *Allocasuarina littoralis* (Black Sheoak), *Eucalyptus leucopyllon* subsp. *cornata* (Yellow Gum) and *Acacia melanoxylon* (Blackwood).

- 15** Remove woody weed species and the existing bluestone barbecue unit, the cyclone mesh fence and the shade structure. Revegetate the large bare area on the plateau with appropriate native grasses. Plant the embankments of the plateau with indigenous species as part of a longer term revegetation strategy.

- 16** Remove all existing debris and rubbish from the site and dispose of it to a legal point of discharge. Place salvaged material such as bluestone pavers, in one designated storage area. Restrict the dumping of materials collected off site, to one main designated storage area. Dispose of contaminated debris and material collected off site to a legal point of discharge. Establish a designated Operational Zone. Construct a security fence to demarcate the zone with one main entry point and install lighting for night work. Configure the Operational Zone to allow Melbourne Water operational staff with large bags and sheets erected for the storage of equipment, materials and off site debris.

- 17** Repair and conserve the interesting 'out of service' reservoir infrastructure relics, such as sections of the pipework and in particular the gate valves and group them to a space either east or west of the former Caretakers residence. Provide interpretive signage to describe the significance of the relics and highlight the historical significance of the items.

- 18** Establish native grasslands to the large bare area to the south end of the site, before it becomes invaded by exotic weed species.

- 19** Remove all large groups of woody weeds located south of the plateau over a number of staged periods. Species to remove include mainly *Pinus radiata* (Monterey Pine) as well as *Ptilosporum undulatum*, (Sweet Pittosporum) and *Cotoneaster pannosus* (Velvet Cotoneaster). Revegetate the area using tree species such as *Eucalyptus cladocalyx* (Sugar Gum) and *E. sideroxylon* (Ironbark).

- 20** Areas that are zoned as Vegetation areas for habitat management have been established and mapped to distinguish the sites within the reservoir which contain the greatest habitat values. Mapping to define these areas helps to guide appropriate use and management of these areas in the long term. Consider installing signage to raise awareness and protect these valuable areas.

EAST SECTION - Reservoir No.2 and No.3

- 21** Remove all *Herdera helix* (Ivy), *H. canariensis* (Ivy) and *Araujia sericifera* (Moth Vine) located around the perimeter fence-line. As these weeds have been left untreated for some time they will be now acting as a screen for neighbours and consultation will be necessary prior to their removal. Monitor for the presence of any of these weed species and act quickly to remove any re-establishing plants.

- 22** The most significant *Herdera helix* (Ivy) and *H. canariensis* (Ivy) infestation to the south east corner of the site involving the adjoining residential properties to the east Melbourne Water has commenced some weed removal to eradicate the Ivy. The ongoing management of the area is to be monitored to prevent the Ivy reoccurring.
- Remove all *Araujia sericifera* (Moth Vine) growing on the wire cage, located on the south boundary, between the Reservoir No.2 and No.3 and dispose of to a legal point of discharge. Remove all other instances of *Araujia sericifera* (Moth Vine) located on site.

- 22** Remove all existing *Pinus radiata* (Monterey Pine) located along the north boundary embankment of Reservoir No.2 and No.3. Remove all existing woody weeds located along the northern embankment over a 5-10 year staged process. Species to be removed include *Ptilosporum undulatum* (Sweet Pittosporum), *Cotoneaster pannosus* (Velvet Cotoneaster), *C. serotinus* (Large Leaf Cotoneaster) and *Cytisus scoparius* (Tree Lucerne).

- 23** Undertake revegetation of the northern embankment using *Eucalyptus leucopyllon* (Yellow Gum) for the upper storey and appropriate ground storey species such as *Eriodia nutans* (Nodding Saltbush), *Atriplex semibaccata* (Creeping Saltbush), *Nesocoma spora* (rough Spear Grass), *Adagioa* (Knead Spear-grass), *Rhagodia candolleana* (Seaberry) and a range of *Dianellas*, to complement the existing young *Acacia*s.

- 23** Remove existing stakes and guards. Plant tubestock of ground cover species such as *Eriodia nutans* (Nodding Saltbush) and *Atriplex semibaccata* (Creeping Saltbush) to help stabilise the embankment. Small bait will be necessary.

- 24** Remove all weed species located along the east embankment of Reservoir No.3 over a number of staged periods. Species to be removed include *Pinus radiata* (Monterey Pine), *Gerrardia liliifolia* (Flex Broom), *Cotoneaster pannosus* and *C. serotinus* (Velvet Cotoneaster and Large Leaf Cotoneaster), *Ptilosporum undulatum* (Sweet Pittosporum), *Acacia baileyana* (Cootamundra Wattle), *Coprosma repens* (Mirror Bush) and *Lycium ferocissimum* (Boxthorn). The removal of weed species is to be carried out carefully to reduce the visual impact upon neighbouring properties and the adjacent East Street. Protect and enhance the large significant patches of *Dianella admixta* (Black-anther Flex-ily).

- 25** Undertake revegetation of the eastern embankment of Reservoir No.3 through the use of *Eucalyptus leucopyllon* (Yellow Gum) for the upper storey, *Acacia implexa* (Lightwood) for the mid storey vegetation and appropriate ground storey species such as *Eriodia nutans* (Nodding Saltbush), *Atriplex semibaccata* (Creeping Saltbush), *Austrosipa scabra* (rough Spear Grass), *A. ligularicata* (Knead Spear-grass), *Rhagodia candolleana* (Seaberry Saltbush) and a range of *Dianellas*.

- 25** Remove all *Cupressus macrocarpa* (Monterey Cypress) located on the south side of Reservoir No.3. Remove all *Nassella trichostoma* (Serrated Tussock), *Nassella mesasiama* (Chilean Needle Grass) and *Eriodia nutans* (Velvet Grass) present at ground level through careful spot spraying with herbicides. Species to remove include *Pinus radiata* (Monterey Pine), *Eucalyptus leucopyllon* subsp. *cornata* (Yellow Gum), *Eucalyptus radiata* (Narrow-leaf Peppermint) for the upper storey, *Acacia implexa* (Lightwood), *Bursaria saligna* subsp. *saligna* (Sweet Bursaria) and *Acacia pycnantha* (Golden Wattle) for the mid storey vegetation and appropriate ground storey species such as *Eriodia nutans* (Nodding Saltbush), *Atriplex semibaccata* (Creeping Saltbush) and *Rhagodia candolleana* (Seaberry Saltbush).

- 26** Remove all existing *Cupressus macrocarpa* (Monterey Cypress) lining the east side of High Street. Maintain 30° grassed slope by staking/mowing the embankment periodically. Darebin City Council requires a replacement plan.

- 27** Supply and install a replacement fence to be located in its present position. Select the species replacing the *C. macrocarpa* making sure no vegetation will overhang the fence to allow people to climb and gain access to the site. Selected trees to replace the *Cupressus macrocarpa* (Monterey Cypress) could comprise of *Allocasuarina littoralis* (Black Sheoak), *Eucalyptus leucopyllon* subsp. *cornata* (Yellow Gum) and *Acacia melanoxylon* (Blackwood).

- 28** Notes: Numbering order does not reflect the priority of the action. Refer to Chapter 7 - Strategies and Actions of the report for the priority of each action.

PRIORITY RATINGS

- HIGH PRIORITY = 1-3 years

- MEDIUM PRIORITY - 4-7 years

- LOW PRIORITY = 7-12 years

DRAFT MASTER PLAN RECOMMENDATIONS- NORTH AND WEST SECTIONS (RESERVOIR No.1) AND EAST SECTION (RESERVOIRS No.2 AND No.3)

PRESTON RESERVOIR LANDSCAPE MASTER PLAN

Client - MELBOURNE WATER

PRINT ISSUE:

SHEET 1 OF 4

REVISIONS:
REV A: Unminded Actions 08-02-19













Drawn: DR
Date: 08-02-19



Michael Smith and Associates
Landscape Architecture and Urban Design
10/100 Fitzroy Street, Melbourne, VIC 3003
Phone: 03 9347 1234
Fax: 03 9347 1234
Tel: 9830 0414 Fax: 9830 2555

In association with
Practical Ecology

LEGEND

-  EXISTING EVERGREEN TREE
-  EXISTING DECIDUOUS TREE
-  EXISTING GROUP OF PREDOMINANTLY EUCALYPT TREES
-  EXISTING AREA OF GRASSLAND AND PHORBES
-  EXISTING WASHINGTONIA ROBUSTA
-  EXISTING BUILDING
- EXISTING MELBOURNE WATER INFRASTRUCTURE (MWM)
-  EXISTING PIT
-  EXISTING ELECTRICAL SERVICE BOX
-  EXISTING LIGHT OR ELECTRICITY POLE
- EXISTING GROUP OF ELECTRICAL PITS (E), WATER VALVES/METERS OR FIRE HYDRANTS (WM)
-  EXISTING SHED
- EXISTING CYCLONE MESH FENCE
- EXISTING SPOON DRAIN (SD) / SWALE
-  PROPOSED AREA OF REVEGETATION
-  PROPOSED AREA OF GRASSLAND REVEGETATION
- PROPOSED BOLLARD OR POST AND RAIL FENCE TO PROTECT IMPORTANT AREAS OF VEGETATION
- PROPOSED CYCLONE MESH FENCE
- REMOVED VEHICLE ACCESS TRACK OR PATH
- REMOVED DEBRIS / DUMPED MATERIAL

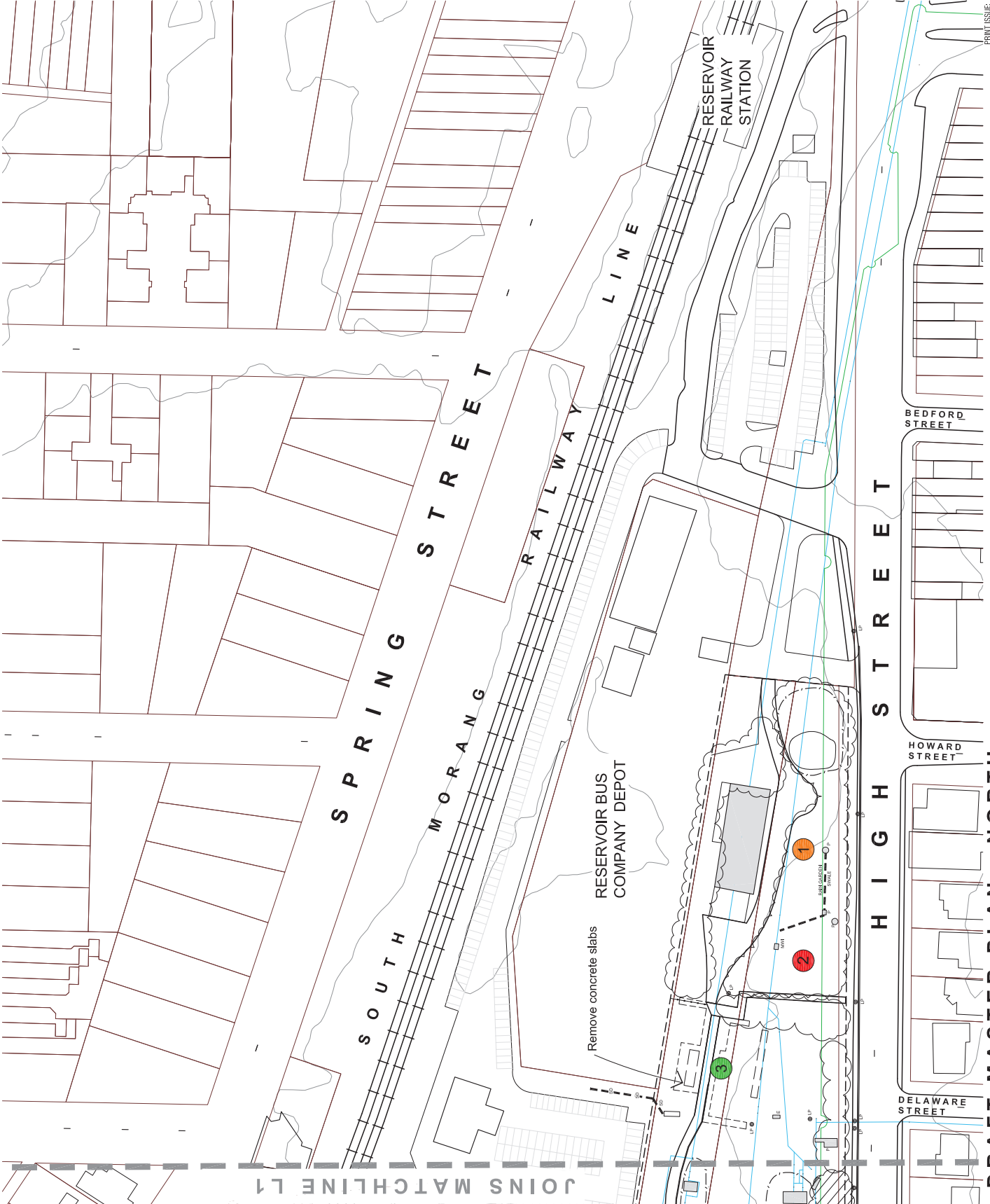

DRAFT MASTER PLAN - NORTH
PRESTON RESERVOIR LANDSCAPE MASTER PLAN
 Client - MELBOURNE WATER

SHEET 2 OF 4



REVISIONS:
 REV A: Text Removed & Amended Actions 08-02-13

Drawn: DR
 Date: 08-02-13

Michael Smith and Associates
 Landscape Architecture and Urban Design
 10/100 High Street, Bayswater, Victoria 3103
 181 9830 0414 Fax: 9830 2555

Michael Smith and Associates
 Practical Ecology
 In association with
 Practical Ecology

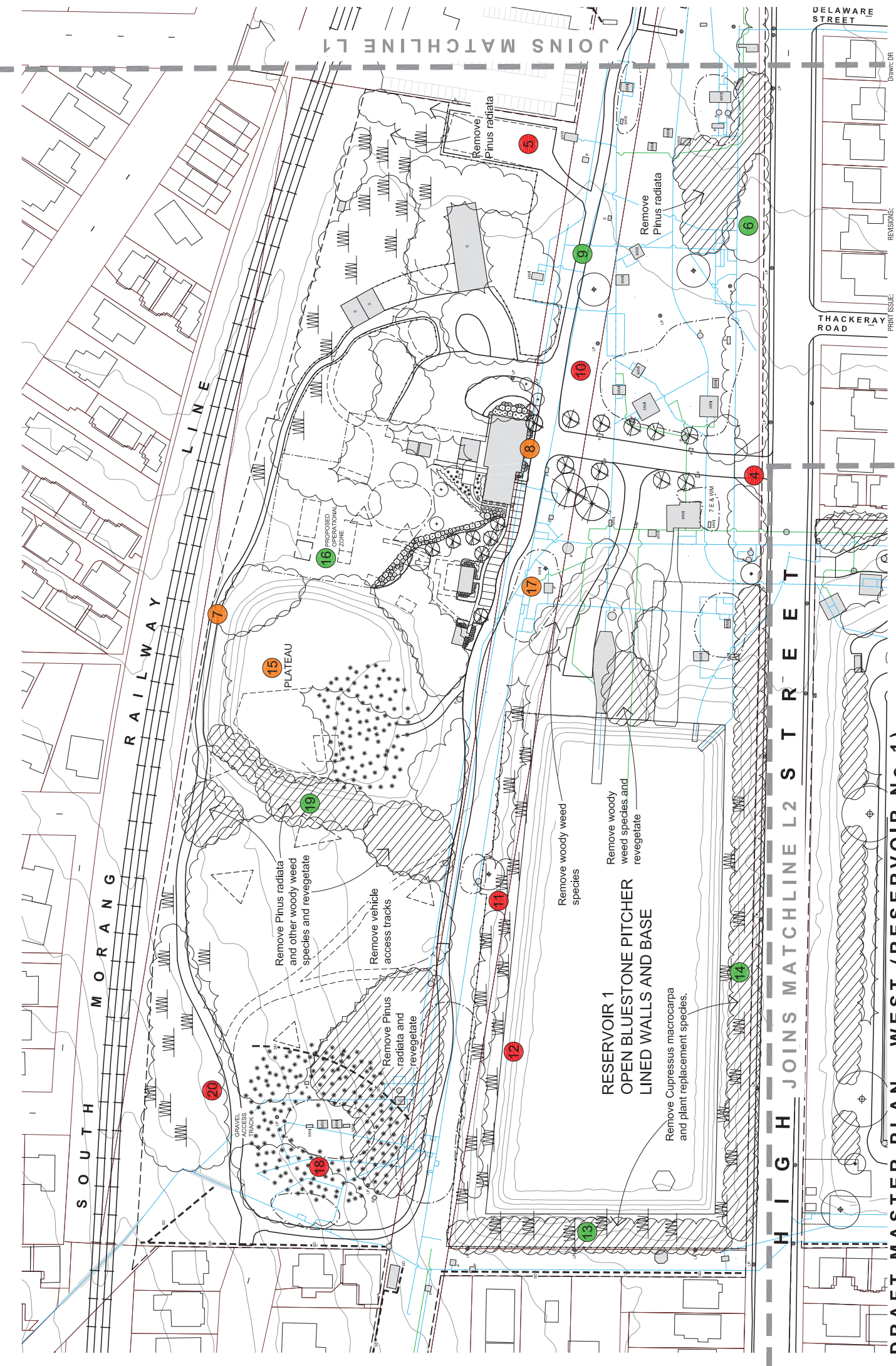

DRAFT MASTER PLAN - WEST (RESERVOIR No.1)
PRESTON RESERVOIR LANDSCAPE MASTER PLAN
 Client - MELBOURNE WATER

SHEET 3 OF 4



PRINT ISSUE:
 REVISIONS:
 REV A: Text Removed & Amended Addone 09-02-13
 Owner: DR
 Date: 05-02-13

MICHAEL SMITH & ASSOCIATES
 Landscape Architecture and Urban Design
 10/11 The Arcade, Melbourne, VIC 3000
 Ph: 03 9630 0124 Fax: 03 9630 0124
 Email: info@msa.com.au
 Website: www.michael-smith.com.au

In association with
Practical Ecology
 3100
 1/11 The Arcade, Melbourne, VIC 3000
 Ph: 03 9630 0124 Fax: 03 9630 2555

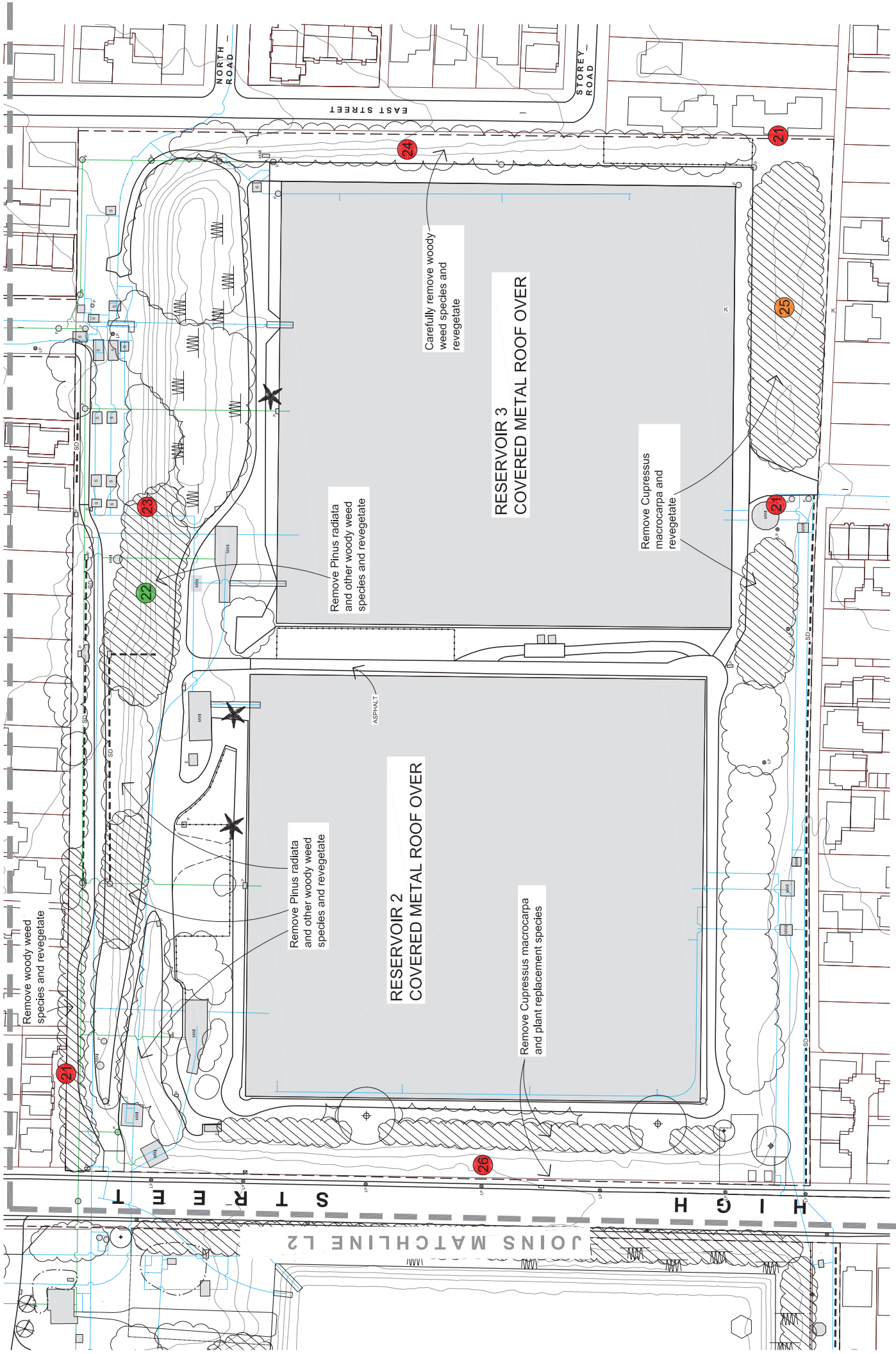

DRAFT MASTER PLAN - EAST (RESERVOIR No.2 AND No.3)

PRESTON RESERVOIR LANDSCAPE MASTER PLAN

Client - MELBOURNE WATER

PRINT ISSUE:

SHEET 4 OF 4

REVISIONS:
REV 'A' Text Removed & Amended Actions 08-02-13

Drawn: DR
Date: 08-02-13

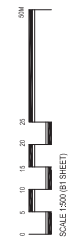

MICHAEL SMITH & ASSOCIATES
LANDSCAPE ARCHITECTS AND URBAN DESIGNERS

Michael Smith and Associates
Landscape Architecture and Urban Design
100/101 Collins Street, Melbourne, Victoria, 3100
Phone: 03 9630 0414 Fax: 9830 2555

In association with
Practical Ecology