

Reimagining Blind Creek Community Bulletin November 2024



Blind Creek and Lewis Park is open

In Melbourne, our waterways and land are essential for our native wildlife and to our way of life. We've got some exciting news - The Reimagining Blind Creek and Lewis Park project is now complete and ready for you to enjoy!

Boardwalk at sunrise



What's happened?

The Reimagining Blind Creek - Lewis Park project has created an open space where people can interact with nature and each other.

In addition to naturalising the creek, we have constructed three new wetlands, a range of paths, a boardwalk and other amenities for the community to enjoy.

Come out and explore the new space - we can't wait for you to experience all that's been created!

The new section of the creek stretches from Scoresby Road into the Lewis Park Precinct, connecting with the works from Scoresby Road to Manuka Drive completed in 2020.

Blind Creek and Lewis Park offers a tranquil setting for all sorts of outdoor activities, including observing the local wildlife.

Enjoy stunning views of the water, vegetation and local habitats from the viewing platform. Ideal for drawing or photography especially at sunrise and sunset. Keep an eye out for ducks and other wildlife making their home here!



Project delivery

In 2018, we worked with Knox City Council to engage local users of Blind Creek and its open space to discuss our plans for the area and seek input into the proposed designs.

We finalised the design concept based on local knowledge, community values and priorities and turned your ideas into reality.

Melbourne Water has lead the project in partnership with Knox City Council, Victoria’s Department of Energy, Environment and Climate Action (DEECA) and Wurundjeri Woi Wurrong Cultural Heritage Aboriginal Corporation.

This is the biggest project in our award-winning Reimagining Your Creek program, turning stormwater drains and concrete channels into vibrant natural spaces.

It’s set to complement the significant investments being made onsite by both Knox City Council, through the Lewis Park Masterplan and the State Government to support the creation of a community hub.

Together with our partners we have been able to transform this land into a place that benefits both the environment and community.

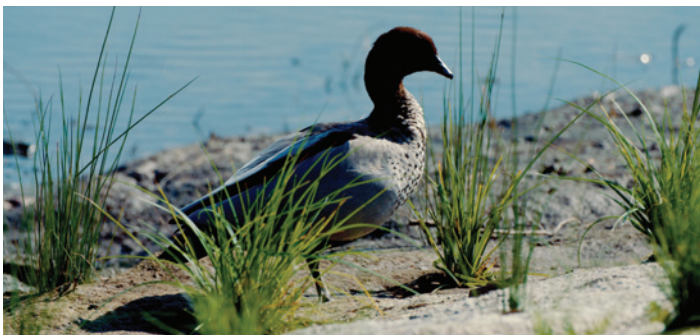

THE PROJECT WORKS INCLUDE:



1.65 kilometres
of Blind Creek naturalised



3 new wetlands



6.3 kilometres of new shared paths



65 metres
of boardwalk through the wetland system for improved access and amenity



676,941 plants
in the area for improved biodiversity outcomes



1,700 new trees
for improved shade and cooling



A number of new community infrastructure assets such as community viewing platforms, pedestrian bridges, stepping stones crossings, benches and tables



2 stormwater harvesting ponds

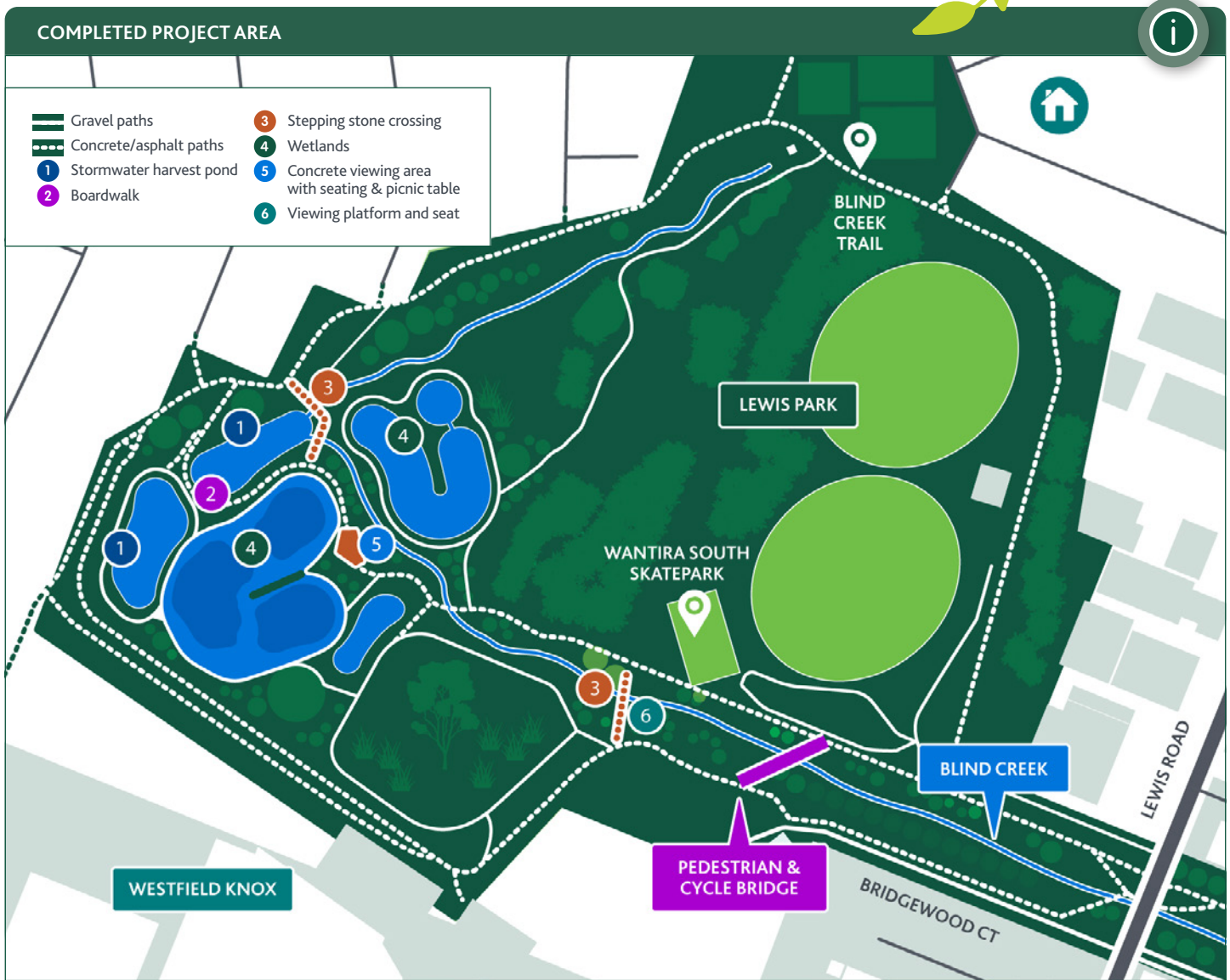



Caring for the environment

Keeping the area clean is vital for preserving the delicate ecosystems and ensuring they remain safe and enjoyable for everyone.

Be sure to keep on the designated walking trails, board walk and stepping stones. These paths allow you to explore safely without disturbing the new plants and animals. Please remember to pick up after your dog and dispose of waste responsibly.

Community safety

The safety of the community is important.

There is no swimming permitted, and please ensure you supervise children at all times. Remember our new local wildlife are settling into this naturalised creek and creating their new homes - to help look after our wildlife please keep your dog on a leash while enjoying the creek and wetlands for everyone's safety.

Thank you

Thank you to our community for joining us on this shared journey – from providing valuable feedback during the design stage to showing patience and understanding through the impacts of construction.

Your contributions and support have helped made this space what it is today. It is now yours to enjoy and our native wildlife to thrive for generations to come.

End of project celebration

Join us to celebrate the opening of your new open space at our free community event. There will be fun activities for all ages including live music and entertainment, education talks, face painting, an adventure hunt and more.

When: Saturday 7 December

Time: 11.00am-2.00pm

Where: Blind Creek and Lewis Park



PROJECT BENEFITS



The project offers a wide range of benefits to the community and environment including:



a more appealing creek environment where people can interact with nature in a cooler, healthier environment



improved waterway health by slowing water flows and establishing plants in and next to the waterway



increase flood mitigation by adding an extra 40,000 cubic meters of flood storage in the retarding basin



activation of open space to enhance community recreation and health and well-being



enhanced biodiversity and habitat for native species, with families of ducks making the area their new home



boosted water security by harvesting stormwater that can be used to irrigate sports ovals and community gardens



improved active transport connections in the area through new sections of shared paths and a bridge



improved water quality flowing through to Dandenong Creek by removing 764 kilograms of nitrogen from the water

KEEPING YOU INFORMED



For more information about The Reimagining Blind Creek and Lewis Park project, contact the project team at:

 1800 875 344

 blindcreek@melbournewater.com.au

 www.melbournewater.com.au

Scan the QR code below for current project information



To access the TTY and Interpreter Services: TTY 133 677
Interpreter: 131 450

